

minimax *line*

si x and elite s range



All “Made in SCM Italy”

From casting iron to finished product.

Come see our production plants and touch the quality of SCM machines;
you will be our guest.



minimax

the passion that deserves professional products.

minimax is the line of professional machines for hobbyists and woodworkers, a point of reference for over 40 years worldwide.

SCM's objective is to guarantee customers high quality technologies which meet their requirements in such a way as to make SCM the partner for any needs.

minimax *si x e elite s*

Maximum expression of professional performances and technology.

circular saw
with double tilting

minimax si x
page 6



combined machines

cu 410es
page 14



st 5es
page 15



planers

fs 52es
page 16



f 52es
page 17



s 52es
page 17



fs 41es
page 18



f 41es
page 19



s 41es
page 19



circular saws

si 400es
page 20



si 315es
page 21



spindle moulders

tw 55es
page 22



t 55es
page 23





App Thundercut

Technology at your fingertips

SCM Thundercut is the Optimizer/Sequencer App for mobile devices, that allows to optimize the panel surface and guides the operator through the cutting sequence.

High cut speed execution, less material waste and mistake odds minimized, even for not skilled workers!

Download it now from the AppStore and Google Play:

SCM Thundercut



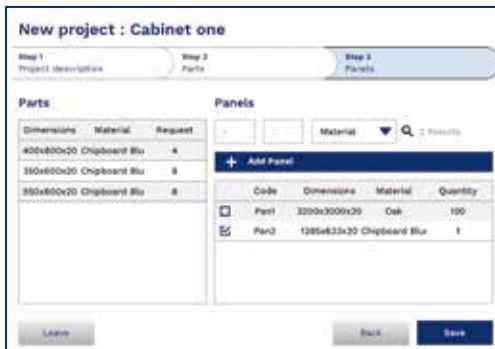
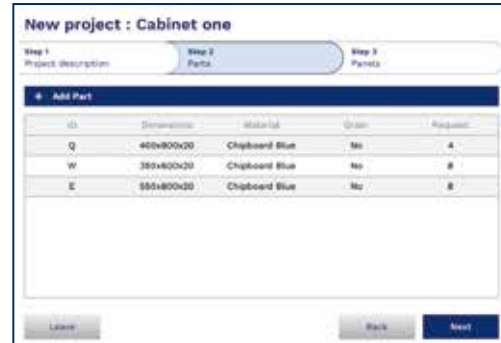
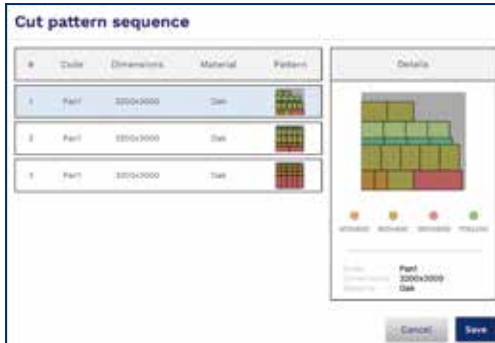

You can manage your circular saws fleet, the material warehouse and many project you are working on.



The 3D sequencer, thanks to its simple and clear design, suggest the ideal settings of the machine for every single cut to be executed.

The App is available for circular saws, circular saws with movable blade unit, saw-shaper combination machines and universal combination machines (you will find the QR code to activate the App in each new machine).

circular saw
with
double
tilting
minimax si x

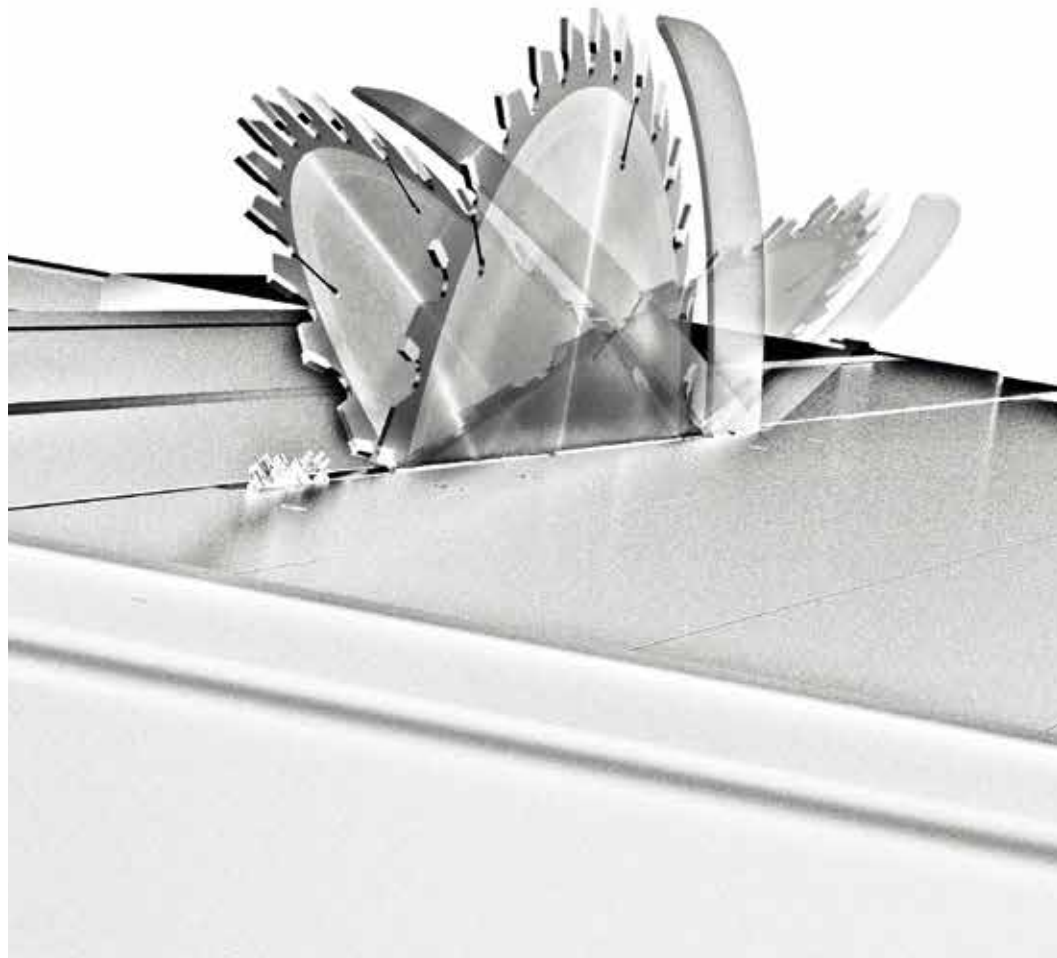

		minimax si x
Max. saw blade diameter with installed scoring unit	mm	400
Max. saw blade projection from the table at 90°/+45°/-45°	mm	136 / 97 / 60
Saw blade rotating speed	mm	1270
Squaring stroke	mm	2600 ÷ 3200
Three-phase motor	kW	7

Find the complete technical specification at page 13



Saw Unit
double tilting



Programmed Movement
simple and quick



Ready 3/Ready 3 UP
automatic positioning



SCM Thundercut
Optimizer/
Sequencer App

Circular saw with $\pm 46^\circ$ double tilting sawblade. It allows simultaneous use of a 400 mm saw blade and 160 mm scoring blade both for 90° cutting and $\pm 46^\circ$ tilted cutting.

minimax si x operating groups

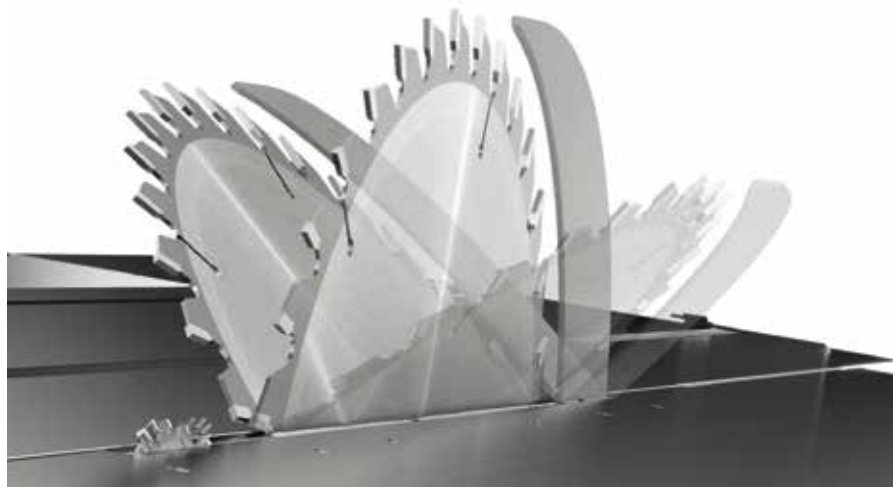

double tilting at
everybody's reach

The $\pm 46^\circ$ tilting of the
unit is done by 2 wide
semi-circular fences.

The lifting of the blade
unit is done by 2
ground cylindric bars.



The scoring blade is adjustable from the outside without tools and allows fast and accurate positioning with no play.

sturdy structure

Saw Unit with $\pm 46^\circ$ double tilting.

Saw unit with a stiff cast-iron structure which can accommodate a blade of 400 mm diameter **with scoring blade installed**. It ensures a perfect and easy cutting of veneer panels and solid wood material with very high thickness. The saw blade uses 100% of the motor power, thanks to the scoring blade with an independent motor as standard.

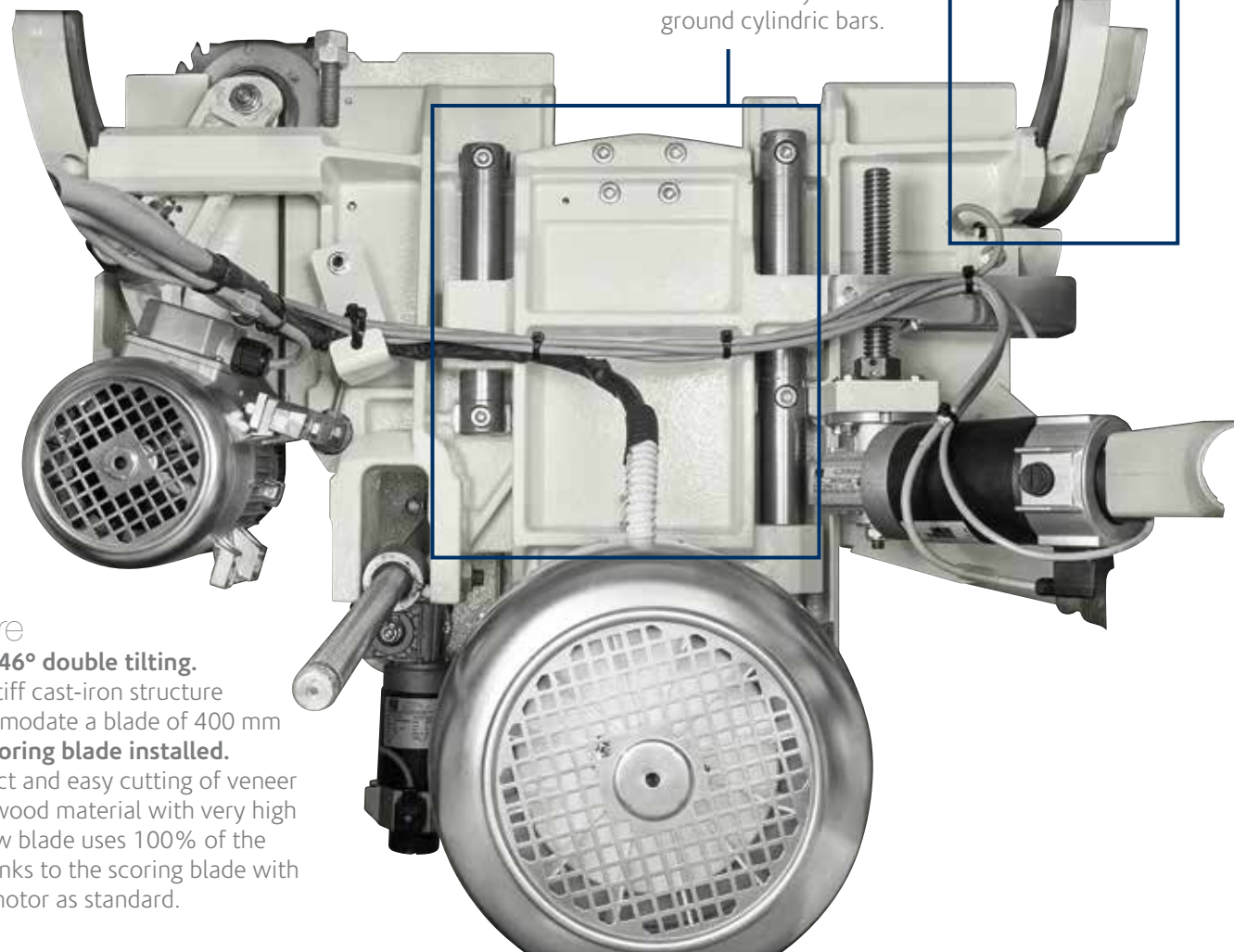



unrivalled cutting finishing
Sliding Carriage.

Optimal support also to larger pieces, with the
new sliding carriage, 360 mm wide.



Exceptional accuracy and smoothness to
secure the guides it is not used glue,
since the thickness could affect sliding.
They are secured with a **procedure
of aluminum riveting.**



Two positions overhead blade protection,
for totally safe machining.



smooth, rapid and
precise positioning
Parallel Fence.

Sliding of the parallel fence support on round
bar with micrometric adjustment.
The support can be also
equipped with digital readout
for fence position with
detecting system on magnetic
band (option). The fence can be
easily excluded from the working area
when it isn't used.



immediate control
Squaring Frame and Fence.

Panel loading is easy on the large squaring
frame with an idle roller at the end.
**The telescopic squaring fence with the
inclined metric scale and two reversible
stops** can be used to square panels measuring
3200x3200 mm and for tilted cuts at up
to 45° on both sides of the frame.

minimax si x electronic controls

simple and quick
Programmed Movement.

The "Ready" control manages the powered and programmed movement of the saw blade unit increasing productivity and working quality.



Ready 3 / Ready 3 UP

Automatic positioning of the parallel fence, from "Ready" control (3 axes).

Programmed or manual fence movement with a hold-down drive for the maximum versatility.

In addition, the Ready 3 UP version has the control on the mobile control panel.

(option)



Digital Readout for the Fence Position on the Parallel Fence.

It allows precise positioning with the magnetic strip sensor.
(option)

maximum practicality

Pushbuttons integrated in the Sliding Carriage.

The possibility to start or stop the blades motors from the pushbuttons located at the ends of the carriage **considerably helps when machining large dimensioned panels.**

(option)



minimax si x

main
optional
devices

tablet holder on the
sliding carriage
Compatible with tablets from 8" to 11".



adjustable tablet holder positioned on
the mobile control panel
Compatible with tablets from 7" to 13".
It is equipped with USB port for power supply positioned
on the mobile control panel.

minimax si x main optional devices

Complex
To rapidly obtain
angular cuttings
with automatic
self-adjustment of
the stops position.

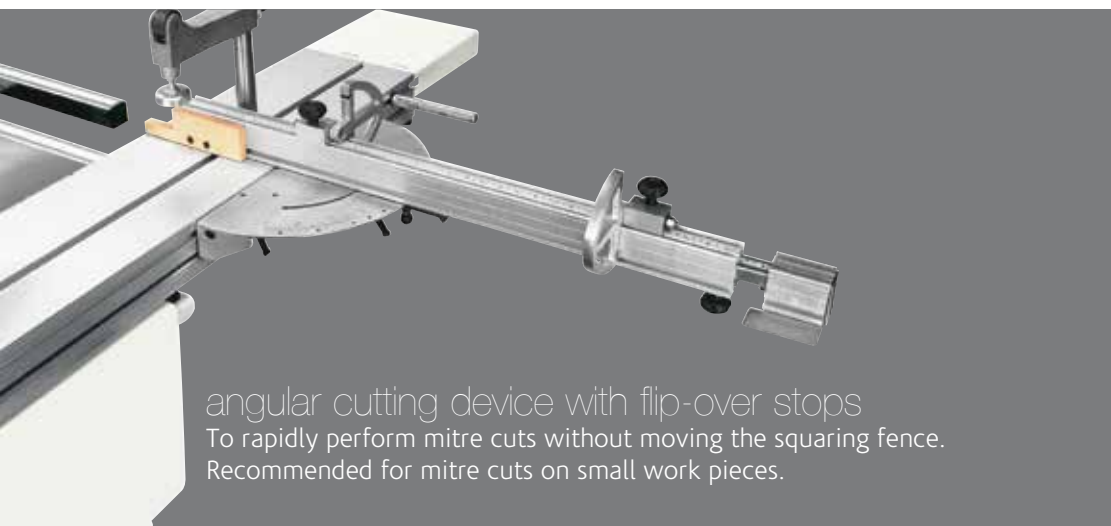

angular cutting device with flip-over stops
To rapidly perform mitre cuts without moving the squaring fence.
Recommended for mitre cuts on small work pieces.

pre-set angular cutting
device directly positioned
on squaring frame
To find rapidly the most common angles
with the squaring fence.
Useful for large work pieces.



expandable scoring
blade
Manually expandable with
variable thickness
from 3,5 to 4,5 mm
(blade diameter: 160 mm).



minimax si x dimensions and technical data

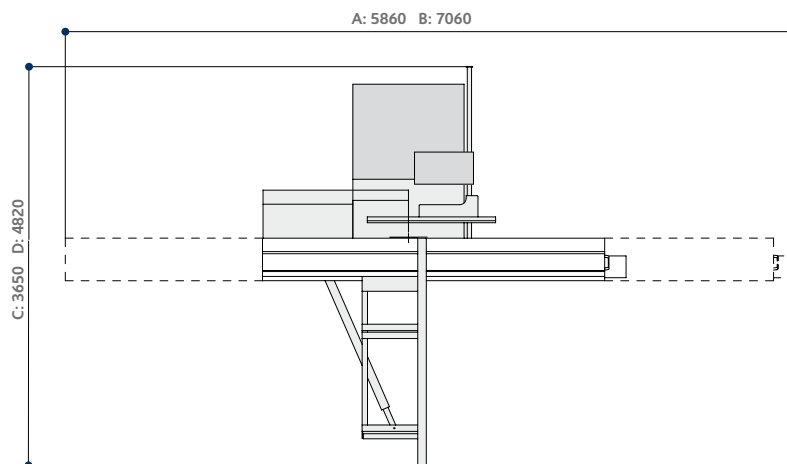

- A** with 2600 mm carriage
- B** with 3200 mm carriage
- C** with manual parallel fence
- D** with Ready 3/Ready 3 Up

- S** Standard
- O** Option

		minimax si x
Cast-iron saw table dimensions	mm	1000 x 685
Blades tilting		-46° ÷ +46°
Max. saw blade diameter with installed scoring unit	mm	400
Max. saw blade projection from the table at 90°/+45°/-45°	mm	136/97/60
Squaring stroke	mm	2600 ÷ 3200
Cutting width on parallel fence	mm	1270
other technical features		
Three-phase motor 7 kW (9,5 hp) 50 Hz - 8 kW (11 hp) 60 Hz		S
"SCM Thundercut" Optimizer/Sequencer App		S
Exhaust hoods diameter:		
- at the base	mm	120
- on overhead protection	mm	80
Pushbuttons integrated in the sliding carriage		O
Squaring frame with "Compex" device		O
Versions "Ready 3" and "Ready 3 UP"		O
Digital readout for the fence position on the parallel fence		O
Angular cutting device with flip-over stops		O
Pre-set angular cutting device directly positioned on squaring frame		O
Adjustable tablet holder positioned on the mobile control panel		O
Tablet holder on the sliding carriage		O
N.2 sawblades speeds (3500/5000 rpm)		O

elite s
 combined machines
 cu 410es universal combined machine
 st 5es saw-spindle moulder



		cu 410es	st 5es
Planer useful working width	mm	410	-
Total length of surfacing tables	mm	2200	-
Max. saw blade diameter with scoring blade installed	mm	350	350
Squaring stroke	mm	2250 ÷ 3200	2250 ÷ 3200
Max. spindle length	mm	125	125
Three-phase motors starting from	kW/Hz	5 (6) / 50 (60)	5 (6) / 50 (60)

Find the complete technical specification at page 28



Saw Unit
unique worldwide



Squaring Fence
immediate control



Spindle Moulder
unsurpassed
moulding



Front Handwheels
ergonomic

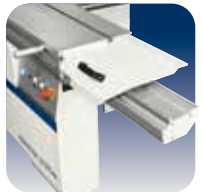

Sliding Carriage
unrivalled cutting
finishing



**SCM
Thundercut**
Optimizer/
Sequencer App

Technology and professional performances in the woodworking combined machines, for an unmatched working precision.

elite s
planers
fs 52es
f 52es
s 52es

surfacing-thicknessing planer
surfacing planer
thicknessing planer



		fs 52es	f 52es	s 52es
Planer useful working width	mm	520	520	520
Cutter block diameter (mm)/no. of standard knives	mm/n.	120 / 4	120 / 4	120 / 4
Total length of surfacing tables	mm	2250	2250	-
Min. ÷ max. working height on thicknesser	mm	3 ÷ 240	-	3 ÷ 240
Three-phase motors starting from	kW/Hz	7 (8) / 50 (60)	5 (6) / 50 (60)	7 (8) / 50 (60)

Find the complete technical specification at page 28

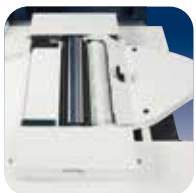

Planer Cutter Block
perfect finishing



Thickening Table
stability over time



Surfacing Tables
fast set-up



Xylent
absolute silence



Planing Fence
absolute rigidity

Professional planers at an accessible price, for woodworking shops and demanding craftsmen that require high standard and no compromises.

elite s
planers
fs 41es
f 41es
s 41es

surfacing-thicknessing planer
surfacing planer
thicknessing planer



		fs 41es	f 41es	s 41es
Planer useful working width	mm	410	410	410
Cutter block diameter (mm)/no. of standard knives	mm/n.	95 / 4	95 / 4	95 / 4
Total length of surfacing tables	mm	2200	2200	-
Min. ÷ max. working height on thicknesser	mm	3 ÷ 240	-	3 ÷ 240
Three-phase motors starting from	kW/Hz	5 (6) / 50 (60)	5 (6) / 50 (60)	5 (6) / 50 (60)

Find the complete technical specification at page 28

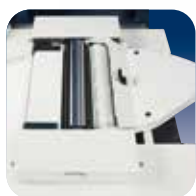

Planer Cutter Block
perfect finishing



Thickening Table
stability over time



Planing Fence
absolute rigidity

Professional planers at an accessible price, for woodworking shops and demanding craftsmen that require high standard and no compromises.

elite s
 circular saws
 si 400es
 si 315es



	si 400es	si 315es
Max. saw blade diameter with installed scoring unit	mm 400	315
Max. saw blade projection from the table at 90°/45°	mm 138 / 98	101 / 71
Cutting width on parallel fence	mm 1270	1270
Squaring stroke	mm 2600 ÷ 3200	2600 ÷ 3200
Three-phase motors power starting from	kW/Hz 5 (6) / 50 (60)	5 (6) / 50 (60)

Find the complete technical specification at page 28



Saw Unit
unique worldwide



Powered Movements
rapidity and precision

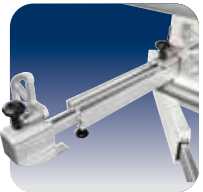

Squaring Fence
immediate control



Sliding Carriage
unrivalled cutting finishing

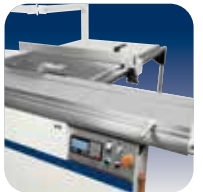

Programmed Fence
for parallel cuttings



SCM Thundercut
Optimizer/
Sequencer App

Professional circular saws with tilting blade for uncompromising quality.

elite s
spindle moulders
tw 55es
t 55es

with fixed or tilting spindle
with fixed spindle



		tw 55es	t 55es
Max. useful spindle length	mm	125	125
Max. tool diameter when profiling	mm	210 ÷ 240	210 ÷ 240
Max. tool diameter lowered under the table at 90°	mm	240	240
Max. tool diameter when tenoning	mm	320 (300 no CE)	-
Three-phase motors starting from	kW/Hz	5 (6) / 50 (60)	5 (6) / 50 (60)

Find the complete technical specification at page 28



Spindle Moulder
unsurpassed
moulding



Moulder Fence
high-tech devices



Sliding Carriage
unrivalled cutting
finishing

The professional spindle moulders that allow for customization and flexibility, for woodworking shops and demanding craftsmen.

elite s operating groups



unique worldwide Saw Unit

Unique in the world in its category, with a cutting height of 118 mm. The cast iron saw unit with a rigid **closed loop structure** can accommodate a blade of 315 and 350 mm diameter (up to 400 mm for *si 400es*) **with the scoring blade mounted**, ensuring perfect and easy cutting of veneer panels and thick solid wood material. The saw blade uses 100% of the motor power, thanks to the **scoring blade with an independent motor as standard**.

The lifting of the blade unit is done by a robust cast iron structure with dovetail system.



The rotation fulcrums of the saw unit have a 120 mm diameter and stand on steady crescent shaped rests that separate it from the base: a rigid reliable solution.



The scoring blade is adjustable from the outside without tools and allows fast and accurate positioning with no play.





high-tech devices
Controls on Carriage.

Wide range of high-tech devices to make your *elite s* even more powerful and personalized, like the **start/stop pushbuttons for the main blade and scoring blade integrated in the sliding carriage**; very useful when machining large dimensioned work pieces that prevent an easy and safe access to the main machine control panel.



immediate control
Squaring Frame and Fence.

Panel loading is easy on the large squaring frame with an idle roller at the end. **The telescopic squaring fence with the inclined metric scale and two reversible stops** can be used to square panels measuring 3200x3200 mm and for tilted cuts at up to 45° on both sides of the frame.



unrivalled cutting finishing
Sliding Carriage.

Optimal support also to larger pieces, with the **sliding carriage 360 mm wide**. Exceptional precision and smoothness: to secure the guides it is not used glue, since the thickness could affect sliding. They are secured with a procedure of aluminum riveting.

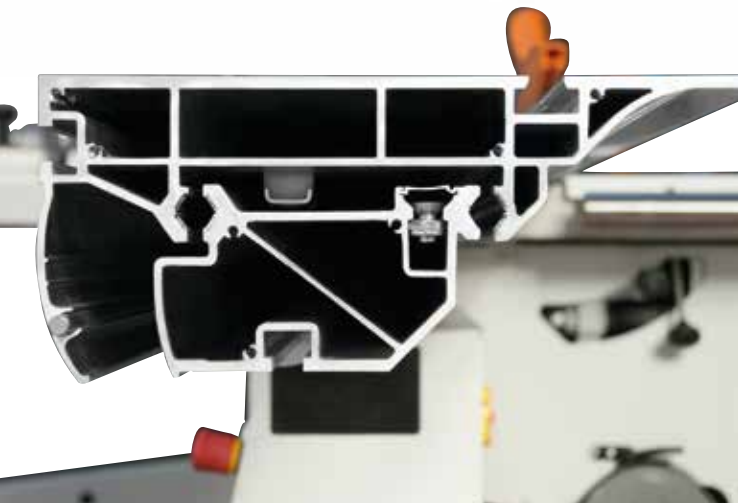

elite s operating groups

absolute rigidity
Planing Fence.
High rigid fence with a smooth
movement thanks to the **central
locking on round bar.**

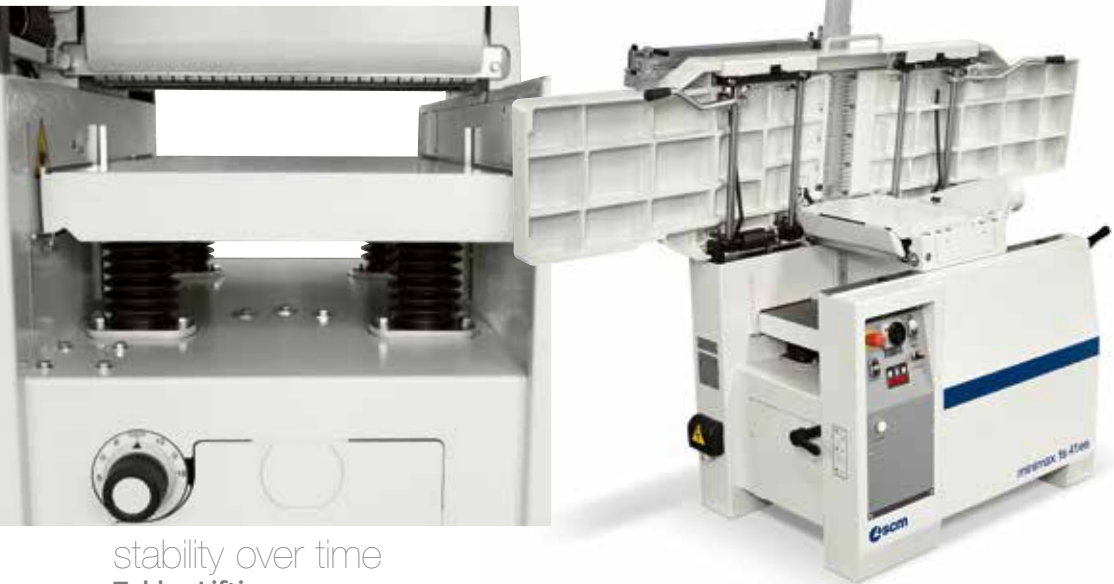

stability over time
Tables Lifting.

Comfortable and precise planing. The *elite s* range adopt ergonomic solutions like the **2200 mm surfacing tables**, in ribbed cast iron, **with simultaneous opening** towards the inside of the machine with a 90° angle. For a maximum long lasting stability the cast iron thickening table lifts on **4 spindles with trapezoidal threads dust protected.**



perfect finishing
Planer Cutter Block.

An optimal planing with minimal effort, thanks to the 95 mm diameter cutter block (120 mm in planers of 520 mm working width) and 4 knives. For an impeccable finish the pressure of the thickener feed rollers can be adjusted according to the type of wood machined. The roller infeed (A) has a **helicoidal profile** to guarantee firm and constant work piece feed, while the outfeed roller (B) in sandblasted steel maintains the perfect post-processing finishing.



A

B

The spindle is surrounded by a cast iron "cup" to **protect the internal mechanical components** from shavings and sawdust.

unsurpassed moulding **Spindle Moulder.**

Maximum stability and rigidity in all working conditions, thanks to a large spindle moulder column made entirely of cast iron. The 4 standard speed are ideal for any type of machining, from moulding to routing and tenoning, with the possibility to fit tools up to 320 mm of diameter (300 mm no CE).



high-tech devices **Moulder Fence.**

The spindle moulder hood uses a system for adjusting the guides with a rack and it is fitted with a mechanical digital readout. Thanks to the **system of memories** (on *t 55es* and *tw 55es* available as option) the hood can be removed and repositioned without losing the machining position. The maximum tool diameter mounted on the spindle lowered under the table at 90° is 240 mm. On request it is available with a spindle that tilts 45° (towards the inside of the machine).

elite s dimensions and technical data

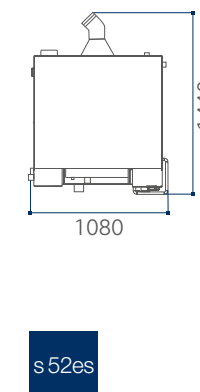
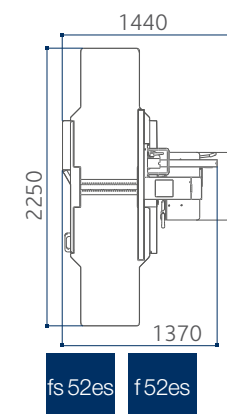
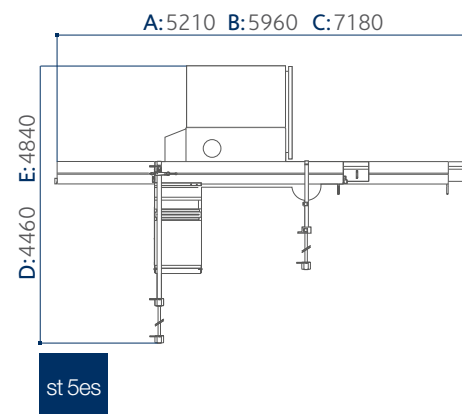
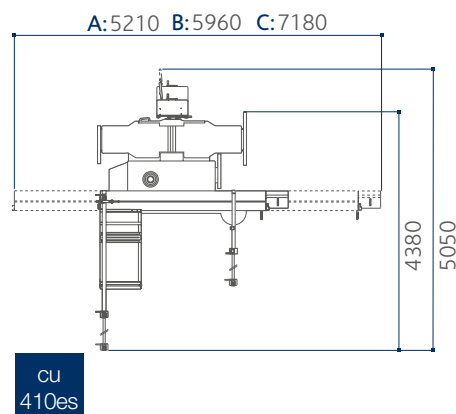

- A with 2250 mm carriage
 - B with 2600 mm carriage
 - C with 3200 mm carriage
 - D with 900 mm cutting width *
 - E with 1270 mm cutting width *
- *at the parallel fence

		cu 410es	st 5es	fs 52es
planer				
Working width	mm	410	-	520
Cutter block diameter (mm)/no. of standard knives	mm/n.	95 / 4	-	120 / 4
Dimensions of standard knives	mm	410 x 30 x 3	-	520 x 30 x 3
Max. stock removal	mm	5	-	5
Surfacing tables total length	mm	2200	-	2250
Thickening tables dimensions	mm	410 x 775	-	520 x 850
Feed speed on thickener	m/min	6 / 12	-	5 / 8 / 12 / 18
Min. ÷ max. working height on thickener	mm	3 ÷ 240	-	3 ÷ 240
circular saw				
Cast iron saw-spindle moulder worktable dimensions	mm	1380 x 465	1380 x 465	-
Saw blade tilting		90° ÷ 45°	90° ÷ 45°	-
Max. saw blade diameter with scoring blade installed	mm	350	350	-
Max. saw blade projection from table at 90°/45°	mm	118 / 84	118 / 84	-
Squaring stroke	mm	2250 ÷ 3200	2250 ÷ 3200	-
Cutting width on parallel fence	mm	1000	900 ÷ 1270	-
spindle moulder				
Max. useful spindle length	mm	125	125	-
Spindle moulder speeds (at 50 Hz)	rpm	3500/6000/8000/10.000	3500/6000/8000/10.000	-
Max. tool diameter when profiling	mm	240	240	-
Max. diameter of tool lowered under the table at 90°	mm	240	240	-
Max. tool diameter when tenoning	mm	320 (300 no CE)	320 (300 no CE)	-
other technical features				
Three-phase motors 5 kW (6,6 hp) 50 Hz - 6 kW (8 hp) 60 Hz		S	S	-
Three-phase motors 7 kW (9,5 hp) 50 Hz with automatic star-delta start		O	O	S
Three-phase motors 9 kW (12 hp) 50 Hz - 11 kW (15 hp) 60 Hz		-	-	O
with automatic star-delta start		-	-	O
Single-phase motors 2,2 kW (3 hp) 50 Hz		-	-	-
Single-phase motors S1 3,6 kW (4,8 hp) 60 Hz		O	O	O
Exhaust outlets diameter	mm	120	120	120

S Standard
O Option

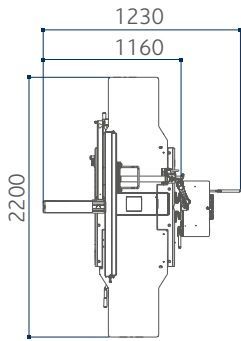

fs 41es f 41es

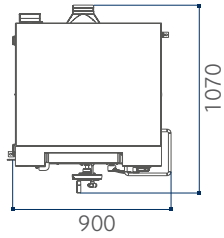

s 41es

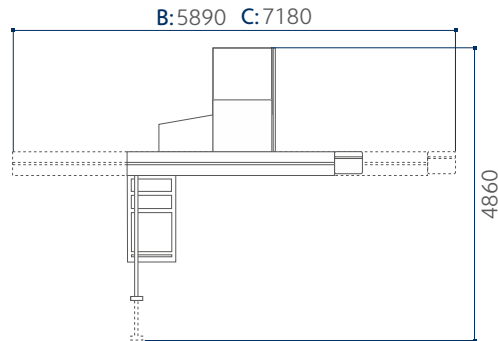

si 400es si 315es

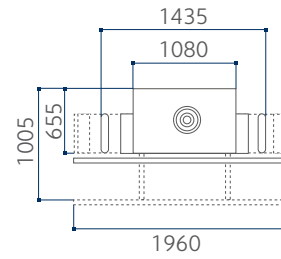

t 55es

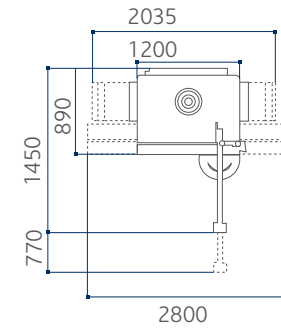

tw 55es

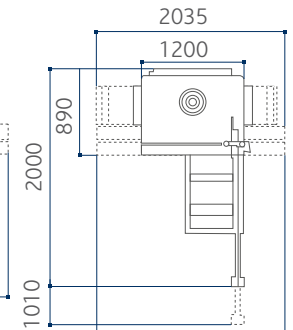

t 55es
with support frame

f 52es	s 52es	fs 41es	f 41es	s 41es	si 400es	si 315es	tw 55es	t 55es
520	520	410	410	410	-	-	-	-
120 / 4	120 / 4	95 / 4	95 / 4	95 / 4	-	-	-	-
520 x 30 x 3	520 x 30 x 3	410 x 30 x 3	410 x 30 x 3	410 x 30 x 3	-	-	-	-
5	5	5	5	5	-	-	-	-
2250	-	2200	2200	-	-	-	-	-
-	520 x 850	410 x 775	-	410 x 775	-	-	-	-
-	5 / 8 / 12 / 18	6 / 12	-	6 / 12	-	-	-	-
-	3 ÷ 240	3 ÷ 240	-	3 ÷ 240	-	-	-	-
-	-	-	-	-	940 x 560	940 x 560	-	-
-	-	-	-	-	90° ÷ 45°	90° ÷ 45°	-	-
-	-	-	-	-	400	315	-	-
-	-	-	-	-	138 / 98	101 / 71	-	-
-	-	-	-	-	2600 ÷ 3200	2600 ÷ 3200	-	-
-	-	-	-	-	1270	1270	-	-
-	-	-	-	-	-	-	125	125
-	-	-	-	-	-	-	3500/6000/8000/10.000	3500/6000/8000/10.000
-	-	-	-	-	-	-	210 ÷ 240	210 ÷ 240
-	-	-	-	-	-	-	240	240
-	-	-	-	-	-	-	320 (300 no CE)	-
S	-	S	S	S	S	S	S	S
O	S	O	-	O	O	O	O	O
-	O	-	-	-	-	-	-	-
-	-	-	-	-	-	-	O	O
O	O	O	O	O	O	O	O	O
120	120	120	120	120	120	120	120	120

elite s main optional devices

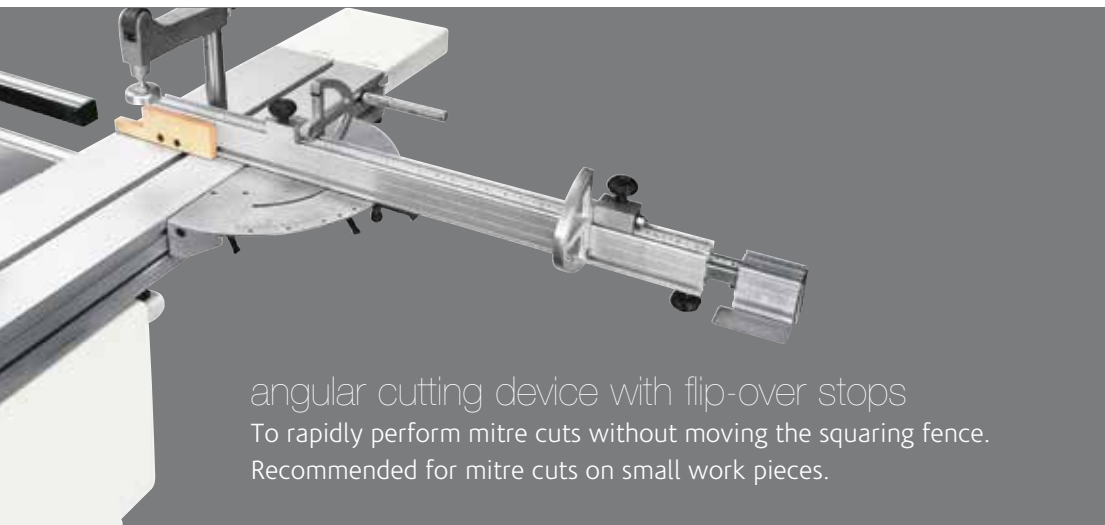

angular cutting device with flip-over stops
To rapidly perform mitre cuts without moving the squaring fence.
Recommended for mitre cuts on small work pieces.



additional table on the sliding carriage
For the support of large dimensioned panels.

pre-set angular
cutting device
directly positioned
on squaring frame
To find rapidly the most
common angles with the
squaring fence. Useful for
large work pieces.

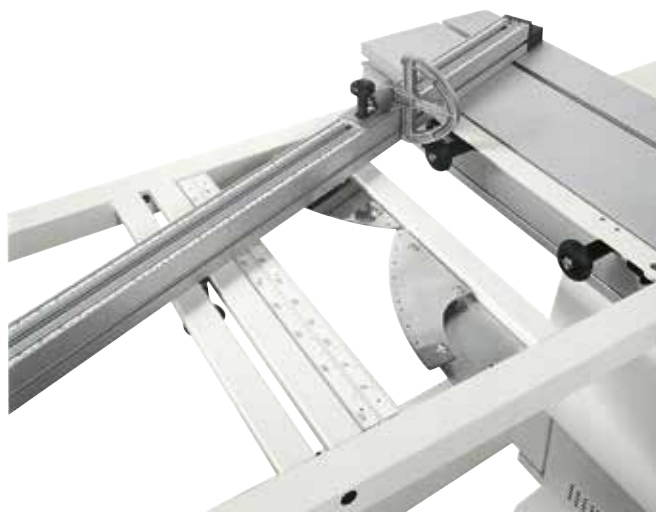

digital readout
for the fence
position on the
parallel fence
It allows precise
positioning with the
magnetic strip sensor.

tablet holder on the sliding carriage
Compatible with tablets from 8" to 11".



cast iron mortiser
Drilling holes and mortises are easily carried out. It is equipped with an exhaust hood, 120 mm diameter and 16 mm chuck.



overhead blade protection
For totally safe machining.



maintenance case for "Xylent" spiralknife

It consists of:

- 1 cleaning/degreasing liquid bottle for the resins cleaning
- 1 set dynamometric key
- 2 bit Torx
- 10 inserts
- 5 screws
- 1 brass bristle brush to clean the spindle with mounted in inserts
- 1 steel bristle brush to clean the inserts housings



"Tersa" cutter block
Automatic knives clamping by means of the centrifugal force ensures safe and precise machining. The system, without fixing screws, makes knives substitution extremely fast.



"Xylent" spiralknife cutter block with 3 series of knives
The 3 spiralknives give an exceptional finish. Reduced noise during machining provides a more comfortable working environment. It also improves the dust extraction due to the production of very small chips. Each cutter has 4 tips which can be rotated into the cutting position when worn. Therefore, increasing the production life of the cutter block before knives require replacement.

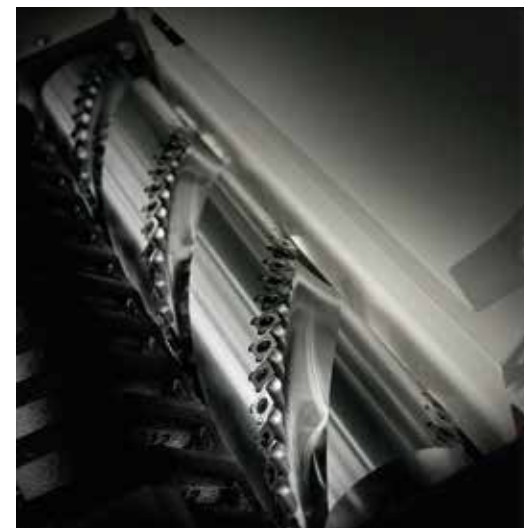

elite s main optional devices



additional overturning
fence for thin work
pieces
It ensures optimum operator safety
when machining thin work pieces.

self-centering chuck
0-16 mm "Wescott" type
The mortiser spindles can be
rapidly substituted without
the necessity of adjustment.



chuck with clamp
It allows harder machining thanks
to the stronger bits. The chuck
includes 3 clamps 5/10/16 mm.



thickening
table with two
removable
idle rollers
It assists the feed for
demanding pieces.



thickening table
extension to be used
in infeed or outfeed
It can be installed on the
worktable end side.

Compex
To rapidly obtain angular
cuttings with automatic
self-adjustment of the
stops position.



pushbuttons integrated
in the sliding carriage
The possibility to start or stop the blades
motors from the pushbuttons located at the
ends of the carriage considerably helps when
machining large dimensioned panels.



Ready 3 /
programmed
parallel fence
Automatic parallel
fence positioning,
available for version
with 1 and 3 axes.



Dado set
Mechanical presetting to
use a tool (not included) in
place of the main blade.



digital readouts
On squaring stops with
micrometric adjustment.



elite s main optional devices

interchangeable
spindle (A)

For a very quick spindle
substitution. Among the spare
spindle, it is available also the
spindle for router bits. (B)



B



tenoning table and
protection hood

For the tenoning operations on the
spindle moulder. It consists of:

- table
- protection hood for tools, 320 mm
diameter (300 mm USA/Canada)
- exhaust hood, 120 mm diameter



roller telescopic
extensions for
spindle moulder

For the machining of work
pieces with large dimensions.



electric pre-setting
and flip over support
for feeder

This solution allows a total exclusion
of the device and prevents interference
with other parts of the machine.

powered handling of the
operating groups with
digital readouts

For the best precision
and easy-to-use.



elite s main optional devices

- S Standard
- O Option
- * Standard for CE and USA/Canada versions

	cu 410es	st 5es	fs 52es	f 52es	s 52es	fs 41es	f 41es	s 41es	si 400es	si 315es	tw 55es	t 55es
"SCM Thundercut" Optimizer/Sequencer App	S	S	-	-	-	-	-	-	S	S	-	-
Angular cutting device with flip-over stops	O	O	-	-	-	-	-	-	O	O	-	-
Pre-set angular cutting device directly positioned on squaring frame	O	O	-	-	-	-	-	-	O	O	-	-
Digital readout for the fence position on the parallel fence	-	O	-	-	-	-	-	-	O	O	-	-
Start/stop pushbuttons for the saw blade and scoring blade integrated in the sliding carriage	O	O	-	-	-	-	-	-	O	O	-	-
Additional table on the sliding carriage	O	O	-	-	-	-	-	-	O	O	-	-
Overhead blade protection	-	O*	-	-	-	-	-	-	O*	O	-	-
"Tersa" cutter block	O	-	O	O	O	O	O	O	-	-	-	-
"Xylent" spiralknife cutter block with 3 series of knives	O	-	O	O	O	O	O	O	-	-	-	-
Maintenance case for "Xylent" spiralknife	O	-	O	O	O	O	O	O	-	-	-	-
Cast iron mortiser	O	-	O	O	-	O	O	-	-	-	-	-
Self-centering chuck 0-16 mm "Wescott" type	O	-	O	O	-	O	O	-	-	-	-	-
Chuck with clamp	O	-	O	O	-	O	O	-	-	-	-	-
Thickening table with two removable idle rollers	-	-	O	-	O	-	-	-	-	-	-	-
Additional overturning fence for thin work pieces	-	-	O	O	-	O	O	-	-	-	-	-
Tenoning table and protection hood	O	O	-	-	-	-	-	-	-	-	O	-
Electric pre-setting and flip over support for feeder	O	O	-	-	-	-	-	-	-	-	O	-
Interchangeable spindle	O	O	-	-	-	-	-	-	-	-	O	O
Roller telescopic extensions for spindle moulder	-	-	-	-	-	-	-	-	-	-	O	O
Powered handling of the operating groups with digital readouts	O	O	O	-	S	O	-	O	O	O	O	-
Compex	O	O	-	-	-	-	-	-	O	O	-	-
Dado set	-	O	-	-	-	-	-	-	O	O	-	-
Digital readouts	O	O	-	-	-	-	-	-	O	O	-	-
Ready 3 / Programmed parallel fence	-	-	-	-	-	-	-	-	O	O	-	-
Tablet holder on the sliding carriage	O	O	-	-	-	-	-	-	O	O	-	-
Thickening table extension to be used in infeed or outfeed	-	-	O	-	O	-	-	-	-	-	-	-

PROMPT AND EXPERT TECHNICAL SUPPORT THROUGH A NETWORK OF 1000 TECHNICIANS AND AN INVENTORY OF 36,000 SPARE PARTS.

HIGHLY SPECIALISED TECHNICIANS, EFFICIENT
MANAGEMENT AND 6 SPARE PARTS BRANCHES
AROUND THE WORLD GUARANTEE A CLOSE,
SAFE AND EFFECTIVE TECHNICAL SUPPORT.

SERVICE

SCM provides a service that goes beyond the purchase, to guarantee the long term performance of your technological production system and peace of mind for your business.

A COMPLETE RANGE OF AFTER-SALES SERVICES

- installation and start-up of machines, cells, lines and systems
- tailored training programs
- telephone support to reduce times and costs when machines are not working
- preventive maintenance programs to guarantee long term performance
- complete renovation of machines and plants to renew the added value of the investments
- custom upgrading to update machines and plants and meet new production requirements



SPARE PARTS

SCM Group can count on 140 spare parts professionals worldwide to meet any request with real time shipments.



36,000 SPARE PARTS

Our spare parts inventory, with a value of 12 million euros, covers every single machine



SPARE PARTS GUARANTEED

We guarantee also hard to find parts, with 3,5 million euros invested in "critical" spare parts.



IMMEDIATE AVAILABILITY

Over 90% of orders received are carried out the same day thanks to the huge inventory available.



6 BRANCHES AROUND THE WORLD

The spare parts service can count on worldwide support (Rimini, Singapore, Shenzhen, Moscow, Atlanta, São Bento do Sul)



500 SHIPMENTS A DAY



THE STRONGEST WOOD TECHNOLOGIES ARE IN OUR DNA

SCM. A HERITAGE OF SKILLS IN A UNIQUE BRAND

Over 65 years of success gives SCM the centre stage in woodworking technology. This heritage results from bringing together the best know-how in machining and systems for wood-based manufacturing. SCM is present all over the world, brought to you by the widest distribution network in the industry.

65+ years history

3 main production sites in Italy

300.000 square metres of production space

20.000 machines manufactured per year

90% export

20 foreign branches

400 agents and dealers

500 support technicians

500 registered patents



In SCM's DNA also strength and solidity of a great Group. The SCM Group is a world leader, manufacturing industrial equipment and components for machining the widest range of materials.

SCM GROUP, A HIGHLY SKILLED TEAM EXPERT IN INDUSTRIAL MACHINES AND COMPONENTS

INDUSTRIAL MACHINERY

Stand-alone machines, integrated systems and services dedicated to processing a wide range of materials.



WOODWORKING TECHNOLOGIES



TECHNOLOGIES FOR PROCESSING COMPOSITE MATERIALS, ALUMINIUM, PLASTIC, GLASS, STONE, METAL

INDUSTRIAL COMPONENTS

Technological components for the Group's machines and systems, for those of third-parties and the machinery industry.



SPINDLES AND TECHNOLOGICAL COMPONENTS



ELECTRIC PANELS



METALWORK



CAST IRON



Company of the Scm Group

registered office:

via Emilia, 77
47921 Rimini, Italia
T. +39 0541 700111
F. +39 0541 700232

sales office:

via Casale, 450
47826 Villa Verucchio, Rimini, Italia
T. +39 0541 674111
F. +39 0541 674274
scm@scmgroup.com
www.scmwood.com

Scm Industria Spa

Professional Workshop Machinery

via Valdicella, 7
47892 Gualdicciolo,
Repubblica di San Marino
scm@scmgroup.com

sales dept. Italy:

T. +378 0549 876911
F. +378 0549 999604

foreign sales dept.:

T. +39 0541 674111
F. +39 0541 674274
www.scmwood.com

The motors powers in this catalogue are expressed in S6, except where otherwise specified. In this catalogue, machines are shown in CE configuration and with options. We reserve the right to modify technical specifications without prior notice, provided that such modifications do not affect safety as per CE norms.

rev.01
03/2021

Mic Studio





SCM GROUP SPA

via Casale 450 - 47826 Villa Verucchio, Rimini - Italy
tel. +39 0541 674111 - fax +39 0541 674274
scm@scmgroup.com
www.scmwood.com



00L0592668E